

KPA6210 Series S type load cells

Features

- Capacities 0-100kg to 0-10T
- Stainless steel construction
- IP67 rating
- Simple installation
- Tension and compression operation
- Weighing or force measurement applications

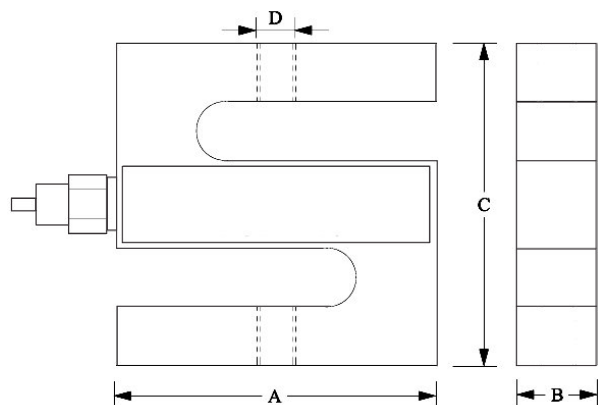

Specifications

Capacities	0-100kg to 0-10T
Nominal output at capacity	2.95 to 3.05mV/V
Non linearity	<0.03% FSO
Hysteresis	<0.05% FSO
Non repeatability	<0.02% FSO
Creep (30 mins)	<0.03% FSO
Temp effect span	15PPM per °C of applied load
Temp effect zero	26PPM per °C of applied load
Compensated temp. range	-10°C to +40°C
Operating temp. range	-40°C to +65°C
Zero Balance	± 1% FSO
Safe load	150% of capacity
Mechanical failure	300% of capacity
Excitation	10V - 15V (max) AC/DC
Input resistance	385Ω ± 15Ω
Output resistance	350Ω ± 3Ω
Environmental protection	IP67
Cable length	6 metres

Wiring Specifications

RED	+ Excitation
BLACK	- Excitation
GREEN	+ Signal
WHITE	- Signal

Order Code

SG-KPA6210-100	Range 0-100kg
SG-KPA6210-150	Range 0-150kg
SG-KPA6210-250	Range 0-250kg
SG-KPA6210-300	Range 0-300kg
SG-KPA6210-500	Range 0-500kg
SG-KPA6210-700	Range 0-700kg
SG-KPA6210-1T	Range 0-1T (1,000kg)
SG-KPA6210-1.5T	Range 0-1.5T (1,500kg)
SG-KPA6210-2T	Range 0-2T (2,000kg)
SG-KPA6210-2.5T	Range 0-2.5T (2,500kg)
SG-KPA6210-5T	Range 0-5T (5,000kg)
SG-KPA6210-7T	Range 0-7T (7,000kg)
SG-KPA6210-10T	Range 0-10T (10,000kg)

Range	A	B	C	D Thread
100kg	51	12	63	1/4" - 28UNF 2B
150kg	51	19	75	1/2" - 20UNF 2B
250kg	51	19	75	1/2" - 20UNF 2B
300kg	51	19	75	1/2" - 20UNF 2B
500kg	51	19	75	1/2" - 20UNF 2B
700kg	51	19	75	1/2" - 20UNF 2B
1t	51	25	75	1/2" - 20UNF 2B
1.5t	51	25	75	1/2" - 20UNF 2B
2t	76	25	108	3/4" - 16UNF 2B
2.5t	76	25	108	3/4" - 16UNF 2B
5t	76	25	108	3/4" - 16UNF 2B
7t	105	32	140	1" - 14UNF 2B
10t	127	50	178	1 1/4" - 12UNF 2B

SG-KPA6210-1.1-0